



**Road Running Technical Council
USA Track & Field
Measurement Certificate**



Name of the course Pickle Run 10K Distance 10 km
Location (state) TX (city) Mansfield
Type of course: Road Race
Measuring Methods: Bicycle
Measured By Gary Brumley, 3509 Cromart Ave, Fort Worth, TX, 76133 - gary@txcourseworks.com - 817.733.8400
Race Contact Amanda Rogers, 4 River Crest Court, Mansfield, TX 76063 - picklequeentx@gmail.com - 817.733.4171
Date(s) when course measured: 03/04/2023
Number of measurements of entire course: 2 Course Configuration: Keyhole
Elevation (meters above sea level) Start 177.00 Finish 177.00 Lowest 170.00 Highest 186.00
Straight line distance between start and finish 0m Drop 0.00 m/km Separation 0.00 %
Type of surface: Paved 100 % Dirt 0 % Gravel 0 % Grass 0 % Track 0 %
Effective date of certification: March 7, 2023 Certification code: TX23014LAB

Note to Race Director: Use this Certification Code
in all public announcements relating to your race.

Be It Officially Noted That

Based on examination of data provided by the above named measurer, the course described above and in the map attached is hereby certified as reasonably accurate in measurement according to the standards adopted by the Road Running Technical Council. If any changes are made to the course, this certification becomes void, and the course must then be recertified.

Verification of Course --- In the event a National Open Record is set on the course, or at the discretion of USA Track & Field, a verification measurement may be required to be performed by a member of the Road Running Technical Council. If such a remeasurement shows the course to be short, then all pending records will be rejected and the course certification will be cancelled.

This certification expires on December 31 of the year: **2033**

AS NATIONALLY CERTIFIED BY:

Date: March 12, 2023

Logan Burgess - USATF/RRTC Certifier - 614 Stillmeadow Drive, Richardson TX 75081
(214) 803-7800 - loganaburgess@yahoo.com



MAP NOT TO SCALE
WGS84 GPS Datum



Pickle Run 10K

Mansfield, TX



USATF Certificate
TX23014LAB
Effective: 03/07/2023
Through: 12/31/2033

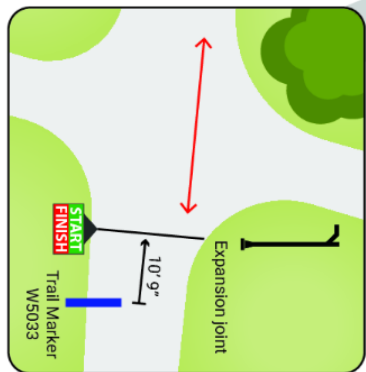
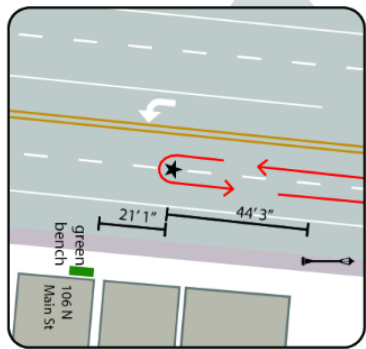
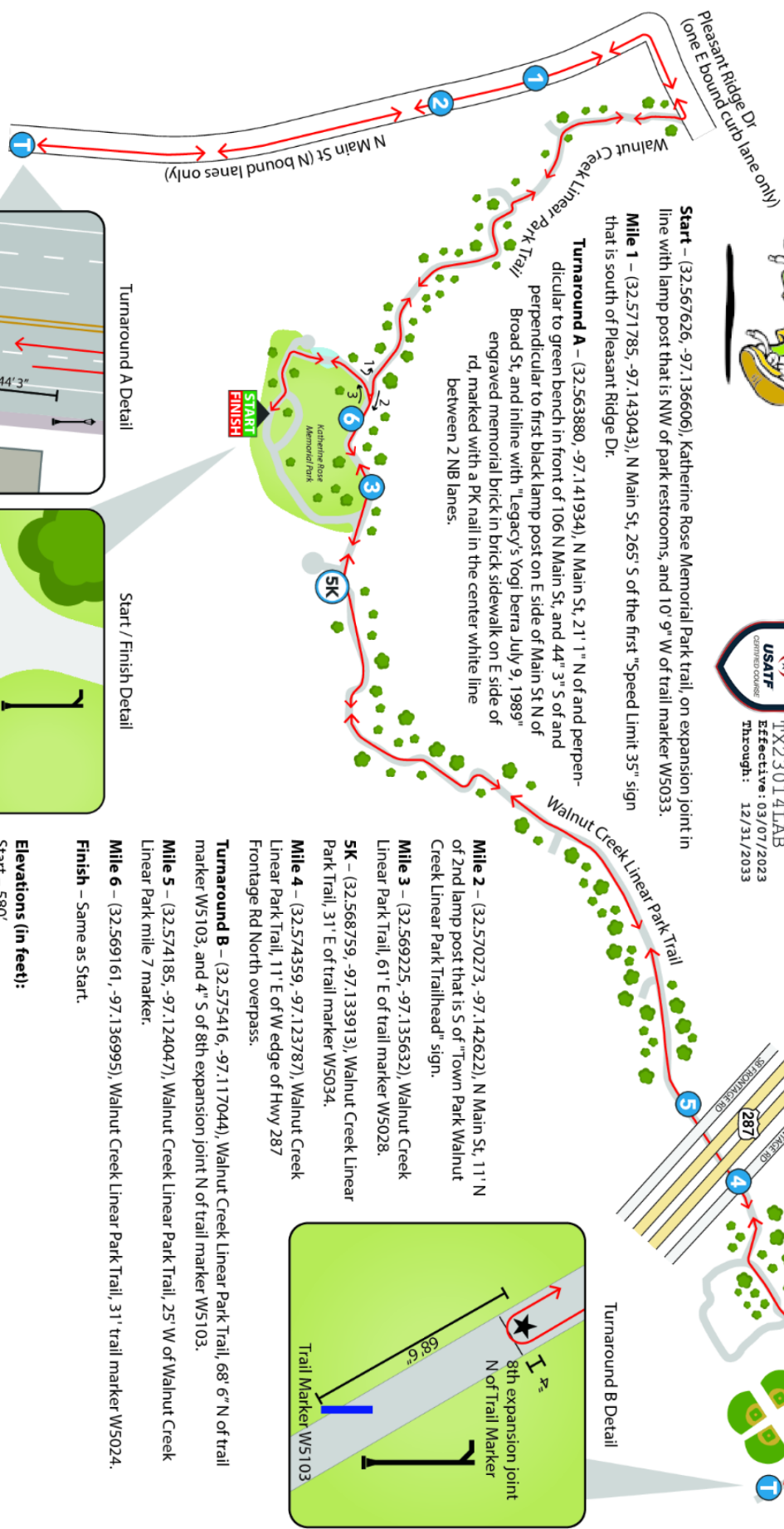

Start – (32.567626, -97.136606), Katherine Rose Memorial Park trail, on expansion joint in line with lamp post that is NW of park restrooms, and 10' 9" W of trail marker W5033.
Mile 1 – (32.571785, -97.143043), N Main St, 265' S of the first "Speed Limit 35" sign that is south of Pleasant Ridge Dr.

Turnaround A – (32.563880, -97.141934), N Main St, 21' 1" N of and perpendicular to green bench in front of 106 N Main St, and 44' 3" S of and Broad St, and inline with "Legacy's Yogi berra July 9, 1989" engraved memorial brick in brick sidewalk on E side of rd, marked with a PK nail in the center white line between 2 NB lanes.

Mile 2 – (32.570273, -97.142622), N Main St, 11' N of 2nd lamp post that is S of "Town Park Walnut Creek Linear Park Trailhead" sign.
Mile 3 – (32.569225, -97.135632), Walnut Creek Linear Park Trail, 61' E of trail marker W5028.
5K – (32.568759, -97.133913), Walnut Creek Linear Park Trail, 31' E of trail marker W5034.
Mile 4 – (32.574359, -97.123787), Walnut Creek Linear Park Trail, 11' E of W edge of Hwy 287 Frontage Rd North overpass.

Turnaround B – (32.575416, -97.117044), Walnut Creek Linear Park Trail, 68' 6" N of trail marker W5103, and 4" S of 8th expansion joint N of trail marker W5103.
Mile 5 – (32.574185, -97.124047), Walnut Creek Linear Park Trail, 25' W of Walnut Creek Linear Park mile 7 marker.
Mile 6 – (32.569161, -97.136995), Walnut Creek Linear Park Trail, 31' trail marker W5024.

Finish – Same as Start.

Elevations (in feet):

Start – 580'
Highest Point – 610'
Lowest Point – 557'
Finish – 580'

This course was measured using the Shortest Possible Route (SPR) given the road restrictions as noted.
Measured on March 4, 2023.



TX COURSE WORKS

www.TXCourseWorks.com
gary@txcourseworks.com

Measured by Gary Brumley
Gary Brumley

Pickle Run 10K

Turn-by-turn directions

No.	Miles	Turn	Direction
1	0		START - Katherine Rose Memorial Park trail, on expansion joint in line with lamp post that is NW of park restrooms, and 10' 9" W of trail marker W5033. Head West on Park Trail.
2	0.043	←	Turn left to keep on Park Trail
3	0.094	→	Turn right to keep on Park Trail
4	0.207	↙	Turn sharp left onto Walnut Creek Linear Park Trail
5	0.515	→	Turn right to keep on Walnut Creek Linear Park Trail
6	0.614	↗	Keep right to stay on Walnut Creek Linear Park Trail
7	0.714	←	Turn left on Pleasant Ridge Dr (restricted to 1 left curb lane)
8	0.867	←	Turn left on Main St (restricted to left lanes)
9	1.55	↶	U-turn and head N on Main St (restricted to right lanes)
10	2.24	→	Turn right on Pleasant Ridge Dr (restricted to 1 right curb lane)
11	2.35	→	Turn right onto Walnut Creek Linear Park Trail
12	2.5	↖	Keep left to stay on Walnut Creek Linear Park Trail
13	2.6	←	Turn left to keep on Walnut Creek Linear Park Trail
14	2.9	→	Turn right to keep on Walnut Creek Linear Park Trail
15	3.04	↖	Keep left to stay on Walnut Creek Linear Park Trail
16	3.101	↖	Keep left to stay on Walnut Creek Linear Park Trail
17	4.1	←	Turn left to keep on Walnut Creek Linear Park Trail
18	4.18	↖	Keep left to stay on Walnut Creek Linear Park Trail
19	4.45	↶	U-turn and head N on Walnut Creek Linear Park Trail
20	4.732	↗	Keep right to stay on Walnut Creek Linear Park Trail
21	4.812	→	Turn right to stay on Walnut Creek Linear Park Trail
22	5.805	→	Turn right to stay on Walnut Creek Linear Park Trail
23	5.86	↗	Keep right to stay on Walnut Creek Linear Park Trail
24	6.002	↖	Keep left onto Katherine Rose Memorial Park trail
25	6.117	←	Turn left to keep on Katherine Rose Memorial Park trail
26	6.165	↗	Keep right on Katherine Rose Memorial Park trail
27	6.21371		FINISH - Katherine Rose Memorial Park trail, on expansion joint in line with lamp post that is NW of park restrooms, and 10' 9" W of trail marker W5033.