



**Road Running Technical Council
USA Track & Field
Measurement Certificate**



Name of the course The Cowtown 5K 2024 Distance 5 km
Location (state) TX (city) Fort Worth
Type of course: Road Race
Measuring Methods: Bicycle
Measured By Gary Brumley - 3509 Cromart Ave - Fort Worth, TX 76133 - () - gary@txcourseworks.com
Race Contact Cindy Peck - 3584 S Hills Ave suite 21, Fort Worth, TX 76109 - +18172070224 - cindy@cowtownmarathon.org
Date(s) when course measured: 02/10/2024
Number of measurements of entire course: 2 Course Configuration: point to point
Elevation (meters above sea level) Start 180.75 Finish 186.84 Lowest 162.76 Highest 186.84
Straight line distance between start and finish 292.61 m Drop -1.22 m/km Separation 5.85 %
Type of surface: Paved 100 % Dirt 0 % Gravel 0 % Grass 0 % Track 0 %
Effective date of certification: February 16, 2024 Certification code: TX24004LAB

Note to Race Director: Use this Certification Code
in all public announcements relating to your race.

Be It Officially Noted That

Based on examination of data provided by the above named measurer, the course described above and in the map attached is hereby certified as reasonably accurate in measurement according to the standards adopted by the Road Running Technical Council. If any changes are made to the course, this certification becomes void, and the course must then be recertified.

Verification of Course --- In the event a National Open Record is set on the course, or at the discretion of USA Track & Field, a verification measurement may be required to be performed by a member of the Road Running Technical Council. If such a remeasurement shows the course to be short, then all pending records will be rejected and the course certification will be cancelled.

This certification expires on December 31 of the year: **2024**

AS NATIONALLY CERTIFIED BY:

Date: February 18, 2024

Logan Burgess - USATF/RRTC Certifier - 614 Stillmeadow Drive, Richardson TX 75081
(214) 803-7800 - loganaburgess@yahoo.com



5K²⁰²⁴

FINISH DETAIL

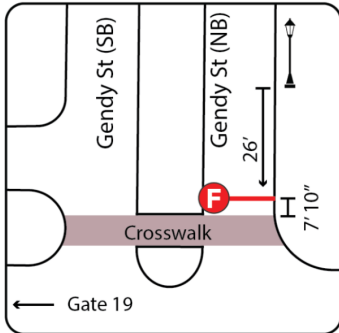

This course was measured using the full width of the road and the Shortest Possible Route (SPR), on February 13, 2024.

Split points and lane restrictions are included on page 2.



USATF Certificate
TX24004LAB
Effective: 02/16/2024
Through: 12/31/2034

START DETAIL

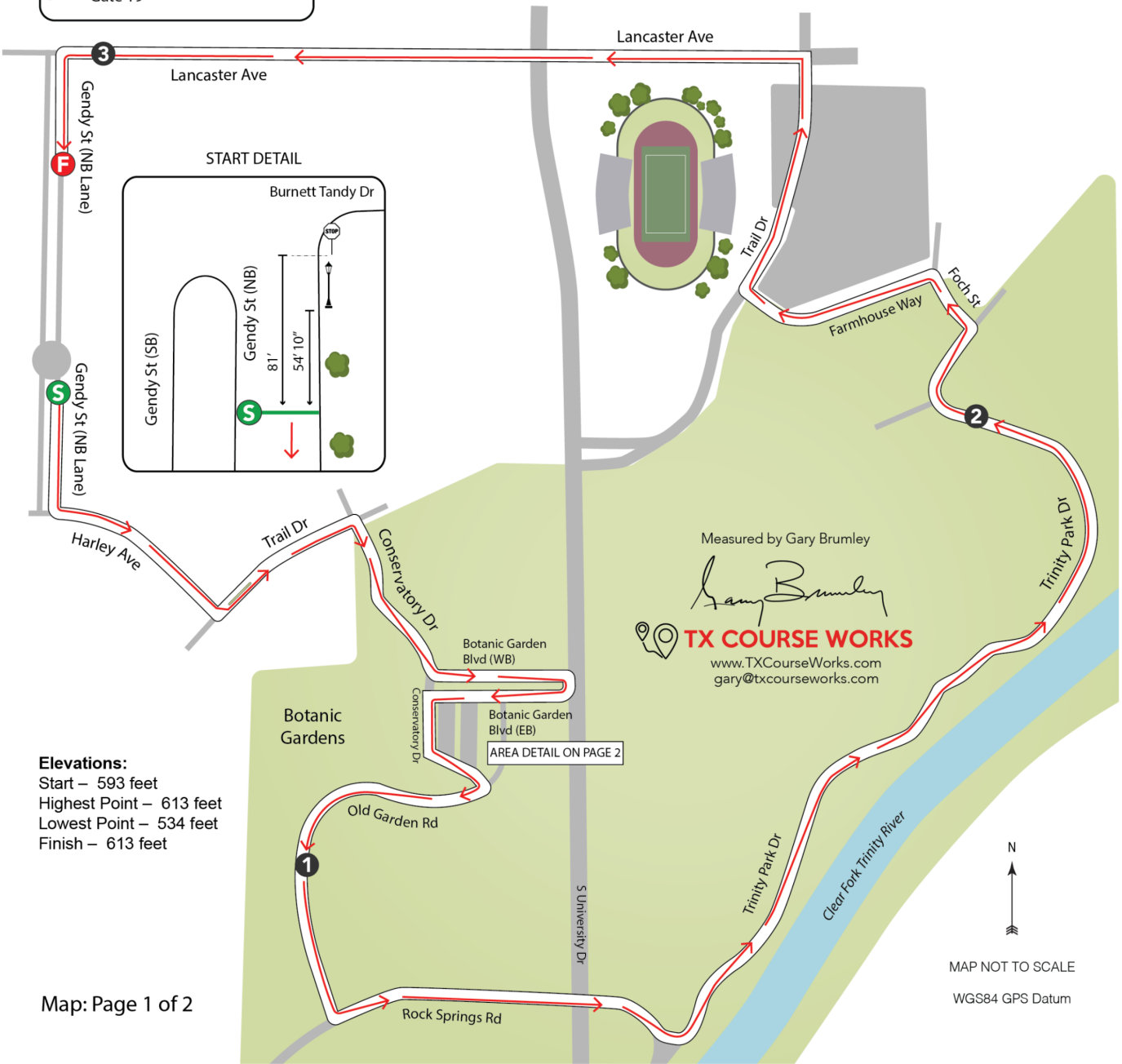
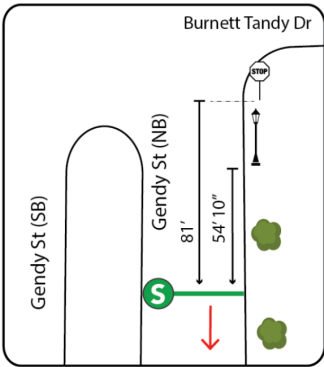

Elevations:
Start – 593 feet
Highest Point – 613 feet
Lowest Point – 534 feet
Finish – 613 feet

Map: Page 1 of 2

Measured by Gary Brumley
Gary Brumley
TX COURSE WORKS
www.TXCourseWorks.com
gary@txcourseworks.com

MAP NOT TO SCALE
WGS84 GPS Datum

WGS84 GPS Datum. GPS coordinates are given only to get close to described locations and NOT to be used to replace lost split point marks. Use the provided measurements from landmarks to reestablish split points.

Mile 1 – (32.737701, -97.365030) – Botanical Gardens, Old Garden Road, 56' S of the first drinking fountain N of Japanese Garden East gate.

Male 3 – (32.747392, -97.367815) – W Lancaster Ave, EB lane, 3’W of “Speed Limit 35” sign E of intersection of W Lancaster Ave and Gendy St.

– LANE RESTRICTIONS –

BOTANIC GARDENS DETAIL

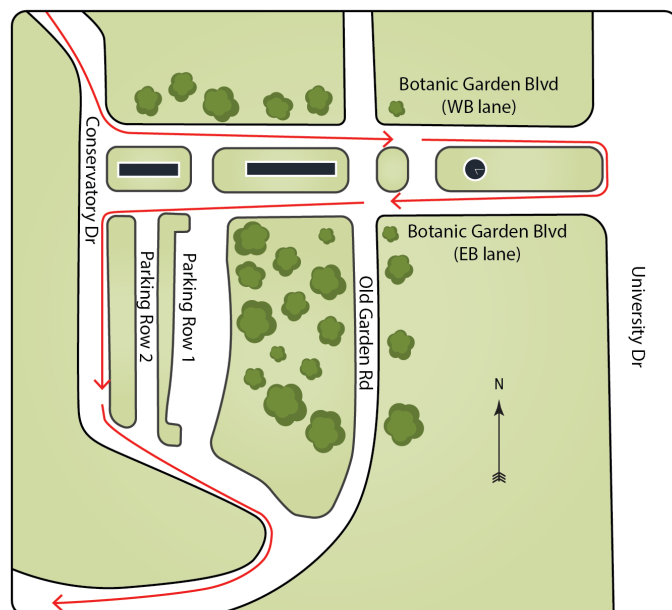

Prepared by
 **TX COURSE WORKS**
www.TXCourseWorks.com