



**Road Running Technical Council
USA Track & Field
Measurement Certificate**



Name of the course Polkafest 5K 2025 Distance 5 km
Location (state) TX (city) Ennis
Type of course: Road Race
Measuring Methods: Bicycle
Measured By Gary Brumley - 3509 Cromart Ave - Fort Worth, TX 76133 - () - - gary@txcourseworks.com
Race Contact Andrew Alvaredo - andrewalvaredo47@gmail.com
Date(s) when course measured: 05/17/2025
Number of measurements of entire course: 2 Course Configuration: loop
Elevation (meters above sea level) Start 159.72 Finish 159.72 Lowest 151.79 Highest 165.81
Straight line distance between start and finish 0 m Drop 0.00 m/km Separation 0.00 %
Type of surface: Paved 100 % Dirt 0 % Gravel 0 % Grass 0 % Track 0 %
Effective date of certification: May 20, 2025 Certification code: TX25022LAB

Note to Race Director: Use this Certification Code
in all public announcements relating to your race.

Be It Officially Noted That

Based on examination of data provided by the above named measurer, the course described above and in the map attached is hereby certified as reasonably accurate in measurement according to the standards adopted by the Road Running Technical Council. If any changes are made to the course, this certification becomes void, and the course must then be recertified.

Verification of Course --- In the event a National Open Record is set on the course, or at the discretion of USA Track & Field, a verification measurement may be required to be performed by a member of the Road Running Technical Council. If such a remeasurement shows the course to be short, then all pending records will be rejected and the course certification will be cancelled.

This certification expires on December 31 of the year: **2035**

AS NATIONALLY CERTIFIED BY:

Date: May 20, 2025

Logan Burgess - USATF/RRTC Certifier - 614 Stillmeadow Drive, Richardson TX 75081
(214) 803-7800 - loganaburgess@yahoo.com

Polkafest 5K 2025

Ennis, TX

This course was measured using the full width of the road and the Shortest Possible Route (SPR), on May 17, 2025. There are no road restrictions.

GPS coordinates are provided solely to assist in approximating the described locations and should not be relied upon as a replacement for lost split point markers. Use the provided measurements from landmarks to reestablish split points.

Start/Finish – (32.327972, -96.629014) – W Knox St, on the first expansion joint E of the lamp post that is on the S side of the road directly in front of the public restrooms at 211 W Knox St, and 21' 6" E of sewer manhole located in the EB lane of Knox St in front of the same address.

Mile 1 – (32.332467, -96.638558) – N Clay St, even with the utility pole between 1004 N Clay St and 611 W Freeman St

Turnaround A – (32.338551, -96.643576) - Park St, center line of road, 4' E of and perpendicular to the utility pole at the SE corner of Park St and Nichols St, and 69' 6" straight line distance from the duck crossing sign E of Nichols St on the S side of Park St

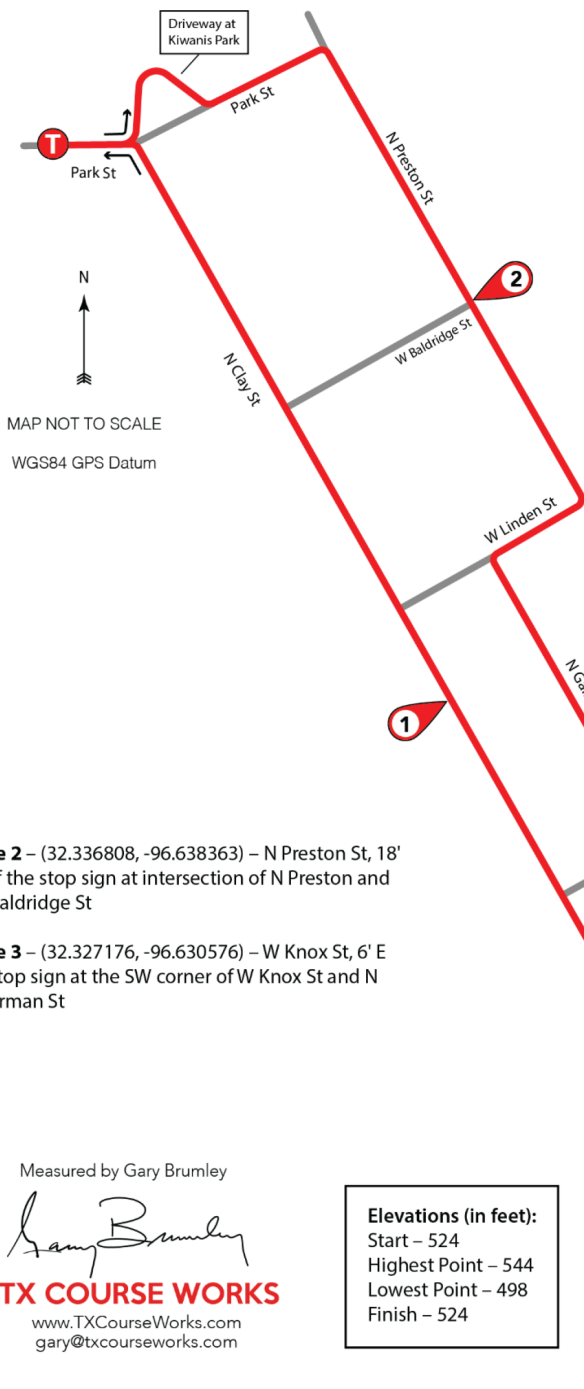

Mile 2 – (32.336808, -96.638363) – N Preston St, 18' N of the stop sign at intersection of N Preston and W Baldrige St

Mile 3 – (32.327176, -96.630576) – W Knox St, 6' E of stop sign at the SW corner of W Knox St and N Sherman St

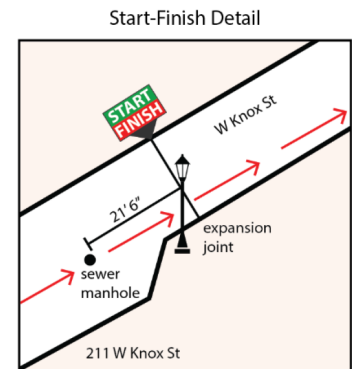
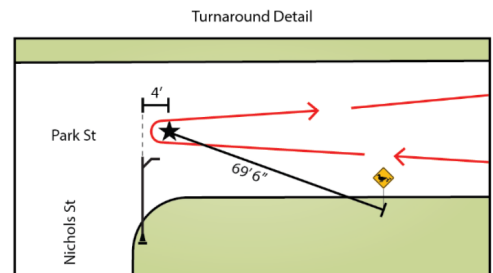

Measured by Gary Brumley

Gary Brumley



TX COURSE WORKS

www.TXCourseWorks.com
gary@txcourseworks.com

Elevations (in feet):
Start – 524
Highest Point – 544
Lowest Point – 498
Finish – 524