



**Road Running Technical Council  
USA Track & Field  
Measurement Certificate**



Name of the course Polkafest 10K 2025 Distance 10 km  
Location (state) TX (city) Ennis  
Type of course: Road Race  
Measuring Methods: Bicycle  
Measured By Gary Brumley, 3509 Cromart Ave, Fort Worth, TX 76133, gary@txcourseworks.com, --  
Race Contact Andrew Alvarado, andrewalvarado47@gmail.com  
Date(s) when course measured: 05/17/2025  
Number of measurements of entire course: 2 Course Configuration: Loop x 2  
Elevation (meters above sea level) Start 159.70 Finish 159.70 Lowest 151.80 Highest 165.80  
Straight line distance between start and finish 0m Drop 0.00 m/km Separation 0.00 %  
Type of surface: Paved 100 % Dirt 0 % Gravel 0 % Grass 0 % Track 0 %  
Effective date of certification: May 20, 2025 Certification code: TX25023LAB

Note to Race Director: Use this Certification Code  
in all public announcements relating to your race.

## ***Be It Officially Noted That***

Based on examination of data provided by the above named measurer, the course described above and in the map attached is hereby certified as reasonably accurate in measurement according to the standards adopted by the Road Running Technical Council. If any changes are made to the course, this certification becomes void, and the course must then be recertified.

**Verification of Course ---** In the event a National Open Record is set on the course, or at the discretion of USA Track & Field, a verification measurement may be required to be performed by a member of the Road Running Technical Council. If such a remeasurement shows the course to be short, then all pending records will be rejected and the course certification will be cancelled.

***This certification expires on December 31 of the year:*** **2035**

**AS NATIONALLY CERTIFIED BY:**

Date: May 20, 2025

Logan Burgess - USATF/RRTC Certifier - 614 Stillmeadow Drive, Richardson TX 75081  
(214) 803-7800 - loganaburgess@yahoo.com

# Polkafest 10K 2025

Ennis, TX

This course was measured using the full width of the road and the Shortest Possible Route (SPR), on May 17, 2025. There are no road restrictions.



## USATF Certificate

TX25023LAB  
Effective: 05/20/2025  
Through: 12/31/2035

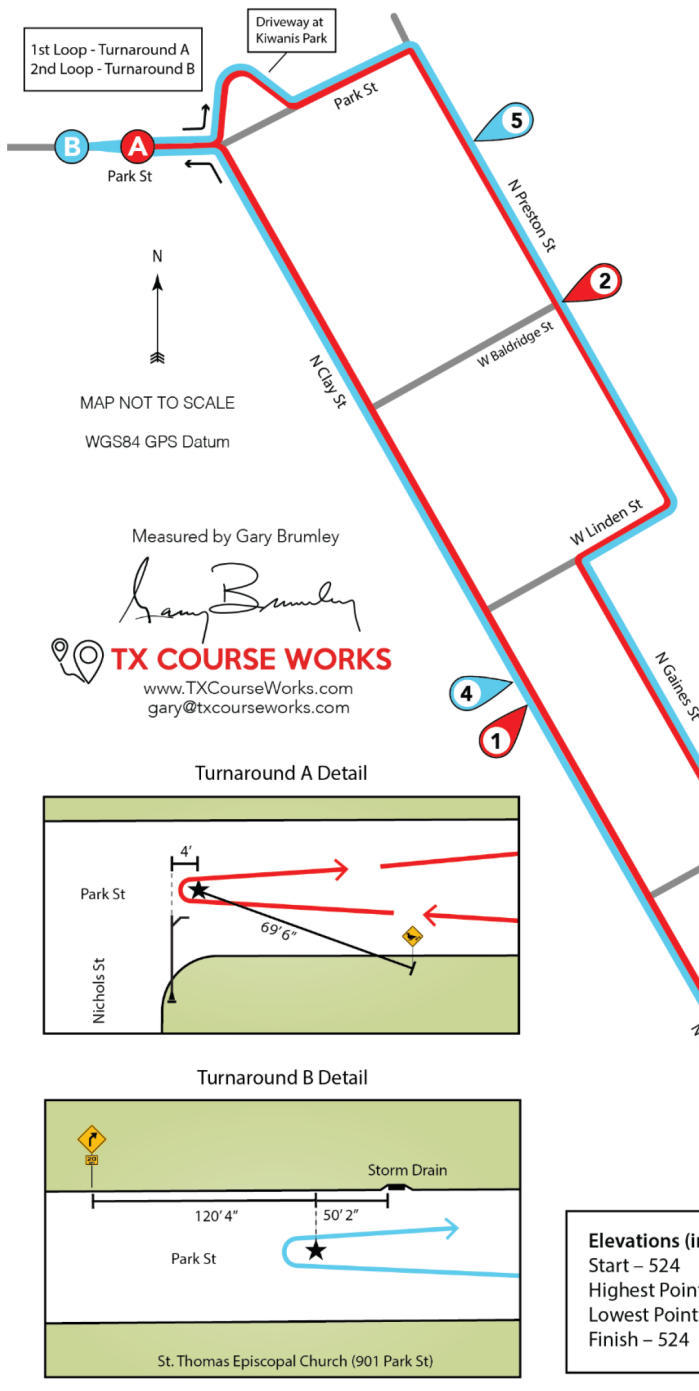

GPS coordinates are provided solely to assist in approximating the described locations and should not be relied upon as a replacement for lost split point markers. Use the provided measurements from landmarks to reestablish split points.

**Start/Finish** - (32.327972, -96.629014) - W Knox St, on the first expansion joint E of the lamp post that is on the S side of the road directly in front of the public restrooms at 211 W Knox St, and 21' 6" E of sewer manhole located in the EB lane of Knox St in front of the same address.

**Mile 1** - (32.332467, -96.638558) - N Clay St, even with the utility pole between 1004 N Clay St and 611 W Freeman St

**Turnaround A** - (32.338551, -96.643576) - Park St, center line of road, 4' E of and perpendicular to the utility pole at the SE corner of Park St and Nichols St, and 69' 6" straight line distance from the duck crossing sign E of Nichols St on the S side of Park St

**Mile 2** - (32.336808, -96.638363) - N Preston St, 18' N of the stop sign at intersection of N Preston and W Baldrige St

**Mile 3** - (32.327176, -96.630576) - W Knox St, 6' E of stop sign at the SW corner of W Knox St and N Sherman St

**5K** - (32.327093, -96.629277) - N McKinney St, 10' N of the 2nd utility pole on W side of rd, N of W Ennis Ave

**Mile 4** - (32.332738, -96.638742) - N Clay St, 38' N of the utility pole at SE corner of N Clay St and W Freeman St

**Turnaround B** - (32.338548, -96.644674) - Park St, center line of road, 120' 4" E of turn caution "20 MPH" sign located on N side of road in front of St. Thomas Episcopal Church, and 50' 2" W of storm drain located on N side of rd at 32.338607, -96.644500

**Mile 5** - (32.338921, -96.639797) - N Preston St, 81' N of the driveway at 1607 N Preston St

**Mile 6** - (32.326458, -96.632235) - W Knox St, center of walkway at 508 W Knox St

### Start-Finish Detail

